

Stamp Clerk
Collector



Stamp for Registrar
1-00 P.M. on the 15th
day of April
1989 at the Dist
Registration Office by
Dehri Prasad Mandal
[Signature]

1) Debi Prasad Mandal
Bhupendra Nath Mandal
of Burdwan P.S. District
by Chitra Chandra By Professor
Doctor

2) Bishu Lakshya Babu
Sri Purandar Lakshya Babu
of Burdwan P.S. District

x Debi Prasad Mandal and as agent for Satya
-kshya Babu, Shovanakshya
Babu, Manojakshya Babu,
Aniyakshya Babu
Under a power of attorney



[Signature]
15/4/89

Service for self
No-57 for 186 Authenticated
by the R.A. Cal + also
Arunakshya Babu under
a power of attorney NO
57

x Debi Prasad Mandal
Bishu Lakshya Babu
for self + as agent
Aniyakshya Babu
Shobhonakshya Babu
Arongiakshya Babu
Aniyakshya Babu
Arunakshya Babu
Nipalakshya Babu
Sri. Mahamaya Babu
Sri. Jayantika Babu
Sri. Jayanti Babu
-56 for 186 authenticated
by the R.A. Cal + also
Utpalakshya Babu under
a power of 597 for 180
authenticated by R.A. Cal +
for also Mahamaya Babu
under a power of attorney
No: 56 for 1987 authentic
calculated by the A.D.S.R.,
Burdwan. + also Sailaja
kshya Babu under a power
of attorney No: 193 for 172
authenticated by the S.R. #
cal + also

REGISTRAR, DEHRI PRASAD MANDAL
BIHAR

15/4/89

[Signature]

[Signature]

630
Dr. D. Jay Prasad Mondol, Naricha
26/12/88
896 of (500 + 300 + 750 + 200 + 10)

[Signature]
Group Clerk
Collector

Amitaksha Das
as agent for
Ambujaksha Das



2/15/89

15/1/89
Jayashree Mohanta + Jayanti Mohanta
under a power of attorney No-120
authenticated by the R.A. Calcutta
3) Anitakshya Babu S/O Anujaksha
Babu of Burdwan Thana & District
By cable Kandi by profession service
as agent for Anujakshya Babu
under a power of attorney No-307
No 183 authenticated by the R.A.

Krishna Kanti Bhunia

Krishna Kanti Bhunia
No. 10, Rabindra Park, Bhubaneswar
Burdwan Thana, Burdwan
District - BURDWAN
By Cable Kandi by profession
Deed Dowles

[Signature]

15/1/89

Dr. Jogi Prasad Mondal, Narich
24/12/83
89607 (500 + 300 + 750 + 200 + 10)

Stamp
Collector



POST OFFICE, NARICH
DISTRICT POST OFFICE

15/1/84



- Selvi Prasad Maudal
1. Anjanaksha Basu
 2. Anuraj Chandra Basu
 3. Shaktikanaksha Basu
 4. Anuroj Chandra Basu
 5. Jayantee Mukherjee
 6. Anilakrishna Basu
 7. Jayanti Mukherjee
 8. Anuraj Chandra Basu
 9. Anuraj Chandra Basu
 10. Anuraj Chandra Basu
 11. Anuraj Chandra Basu
 12. Anuraj Chandra Basu
 - 13.
 - 14.
 - 15.

1. Anuraj Chandra Basu
 2. Anuraj Chandra Basu
 3. Anuraj Chandra Basu
 4. Anuraj Chandra Basu
 5. Anuraj Chandra Basu
 6. Anuraj Chandra Basu
 7. Anuraj Chandra Basu
 8. Anuraj Chandra Basu
 9. Anuraj Chandra Basu
 10. Anuraj Chandra Basu
 11. Anuraj Chandra Basu
 12. Anuraj Chandra Basu
 13.
 14.
 15.

Dr. Debi Prasad Mondal, Naricha
26/12/88
89.607 (500 + 300 + 750 + 200 + 10)

26/12
Stamp
Collector



GOVERNMENT OF WEST BENGAL
W.B.A.U.

15/4/83

630

Dr. Debi Prasad Mondol, Nalich
26/12/88
89.60 (500 + 300 + 750 + 200 + 10)

[Signature]
Stamp Clk
[Illegible text]



RECEIVED (10/12) 89.60
at NALICH, DISTRICT

18/12/88



STATE OF NEW YORK
OFFICE OF THE ATTORNEY GENERAL

1874/83



DEPARTMENT OF REVENUE
TAMIL NADU

15/11/83



~~CONFIDENTIAL~~
15/4/83



REGISTERED

15/4/89

15/4/89
1989



REGISTRATION NO. 52
190
1989

[Handwritten signature]

50000

Land of debi Prasad Mandal coloured Blue in this plan of plot
No. 100 Khaja Anower Ber Jh. No. 36. Kh. No. 172 P.S. & Dist. Burdwan is being exchanged
with the land of Bishalakra Basu & others coloured Red in this plan of plot No. 100
Mouza Radhanagar J.L. No. 39. Kh. No. 34. P.S. & Dist. Burdwan.

Original.

MOUZA. RADHANAGAR J.L. NO. 39
P.S. & DIST. BURDWAN
SCALE: - 3 3/4" = 1" INCH.

N. BASU ROAD -> TO G.T. ROAD

HOUSE OF SHYAMALITA HARRA
LAND OF KABITA RANI MANDAL

MOUZA. KHAJA ANOWER BER JH. NO. 36
P.S. & DIST. BURDWAN
SCALE: - 3 3/4" = 1" INCH.

KHAJA ANOWER BER ROAD.

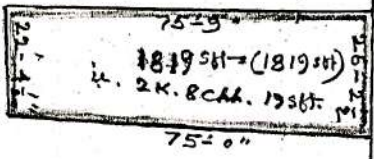
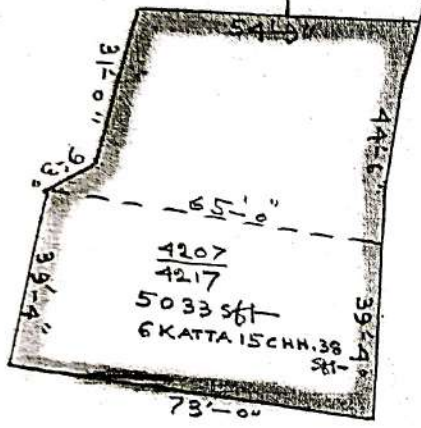

SIGNATURE OF 2nd PARTY.

Sarojakesha Basu Sarojakesha Basu

Ambujaksha Basu
Khadimachary Basu
Amijaksha Basu
Mondjaksha Basu

Jayanti Mitra
Kailajaksha Basu
Jayanti Mitra
Utpalaksha Basu
Bishalakesha Basu

সরোজেশ্বর বসু
Sarmaksha Basu

SIGNATURE OF 1st PARTY.

~~Sarojakesha Basu~~
Debi Prasad Mandal



Drawn by
R.N. Gaiswas.
Burdwan.

190

15/11/87

অসমীয়া-ইংৰাজী কালমা সূচী

195
কলিমা-ইংৰাজী-ইংৰাজী-কলিমা-ইংৰাজী-কলিমা-ইংৰাজী-কলিমা-ইংৰাজী

1 No. 017
All of
1961
1962

Handwritten notes at the top of the page, including "L. No. 017" and "All of 1961 1962".

Case No.	190
Volume No.	8787
Page No.	198
Year	1989

John R. 253

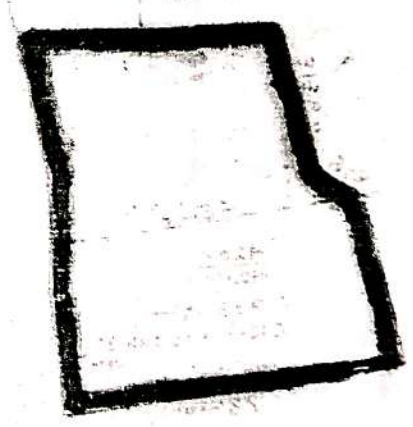

Handwritten signature or initials at the bottom right of the page.